

WP
MODEL

**POWER
PALLET TRUCK**

**CAPACITY
1.5 ton**

**LIFTING HEIGHT
120 mm.**



WP60-15

WP17-15

WP17-15Li3

Model

**WP60-15
WP17-15G
WP17-15Li3
WP17-20Li3**

**DC DRIVING SYSTEM
DC LIFTING MOTOR
MAINTENANCE FREE BATTERY**

**Reliable ride to speed up time
by tough engineered truck**

 **DRAWINGS FOR
SPECIFICATIONS**

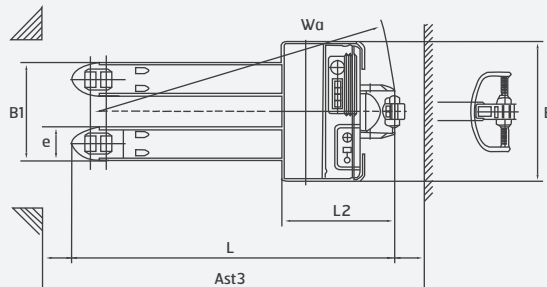
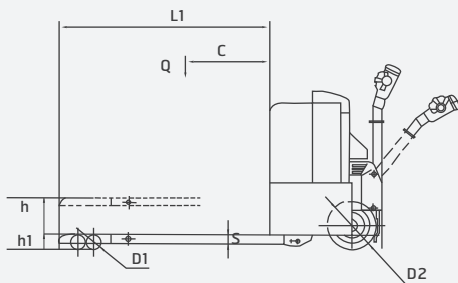

SPECIFICATIONS

MODEL				WP60-15	WP17-15G	WP17-15Li3	WP17-20Li3
CHARACTERISTICS	Q	Capacity	kg	1500	1500	1500	2000
	C	Load Centre	mm	600	600	600	600
		Operator Type		walkie	walkie	pedestrian	pedestrian
		Electric Power Steering (Eps)		unavailable	unavailable	unavailable	unavailable
SPECIFICATIONS	h	Lifting Height	mm	120	120	200	200
	h1	Ground Clearance+fork Thickness	mm	74/85	85	35	35
	B1	Standard Fork Width	mm	540/685	550/685	550/685	550/685
	L1	Fork Length	mm	1150/1200	1150/1200	1150/1200	1150/1200
	S	Fork Thickness	mm	44	55	50	50
	E	Fork Width	mm	160	165	150	150
	L	Overall Length	mm	1570/1620	1707	1550	1550
	L2	Rear Length	mm	420	-	400	400
	B	Overall Width	mm	704	697	550/685	550/685
	Wa	Minimum Turning Radius	mm	1505/1555	1547	1345	1345
	Ast3	Aisle Width (800*1200mm Pallet): Horizontal/vertical	mm	2105/2205	1920	1800	1800
	Ast3	Aisle Width (1000*1200mm Pallet): Horizontal/vertical	mm	2255/2305	1953	1750	1750
	PERFORMANCE	Maximum Traveling Speed	Laden	Km/h	4.6	3	4.2
Unladen			Km/h	5.9	3.5	4.5	4.5
Maximum Lifting Speed		Laden	m/s	0.056	0.056	0.056	0.056
		Unladen	m/s	0.06	0.06	0.06	0.06
Maximum Lowering Speed		Laden	m/s	0.057	0.057	0.057	0.057
		Unladen	m/s	0.059	0.059	0.059	0.059
Gradeability	Laden	%	5	5	5	5	
	Unladen	%	7	7	10	10	
WEIGHT	Service Weight Without Battery		kg	244	227	227	227
	Service Weight With Battery		kg	292	275	253	235
CHASSIS	Wheel(Drive/load) Type			PU	PU	PU	PU
	Wheel Quantity(Drive/load)			1D+4L/1D+2L	1D+4L	1D+4L	1D+4L
	D1	Size Of Steering Wheel	mm	Ø 252x63	Ø2 52x67	Ø 210x70	Ø 210x70
	D2	Size Of Loading Wheel	mm	Ø 80x58(double wheel)	Ø 80x70(double wheel)	Ø 80x60	Ø 80x60
	Size Of Balance Wheel		mm	Ø99.5x40	-	-	-
	Wheel Base		mm	1222/1272	1301	1190	1190
	Travelling Motor		kw	0.6 DC	0.63 DC	0.75 DC	0.75 DC
DRIVING SYSTEM	Lifting Motor		kw	0.8 DC	0.8 DC	0.8 DC	0.8 DC
	Battery Capacity/Type		v/Ah	24v/70Ah maintenance free battery	24v/70Ah maintenance free battery	24v/30Ah LFP	48v/10Ah LFP
	Maximum Battery Box Size(L*W*H)		mm	258x166x208mmx2	-	-	-
	Travelling Brake			regenerate	regenerate	regenerate	regenerate
	Brake Type			electromagnetic	electromagnetic	electromagnetic	electromagnetic
	Control System			CURTIS 1243	CURTIS	CURTIS	CURTIS

*The Specification is subject to change without prior notice.